

250

200

150

100

50

1

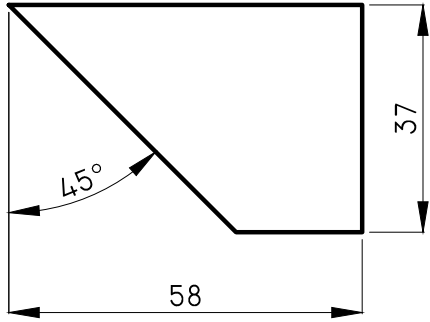

2

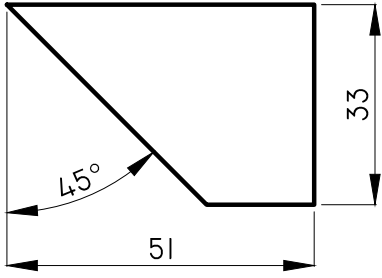

3

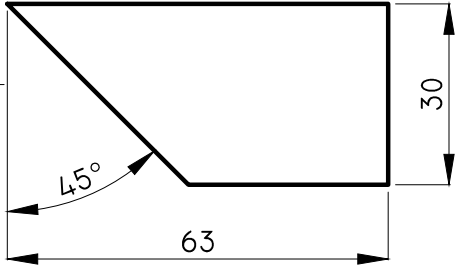

4

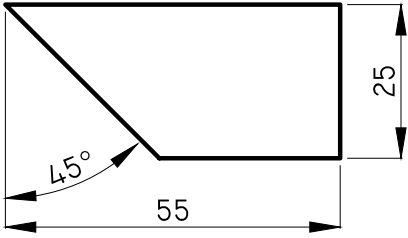

5

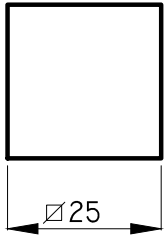

6

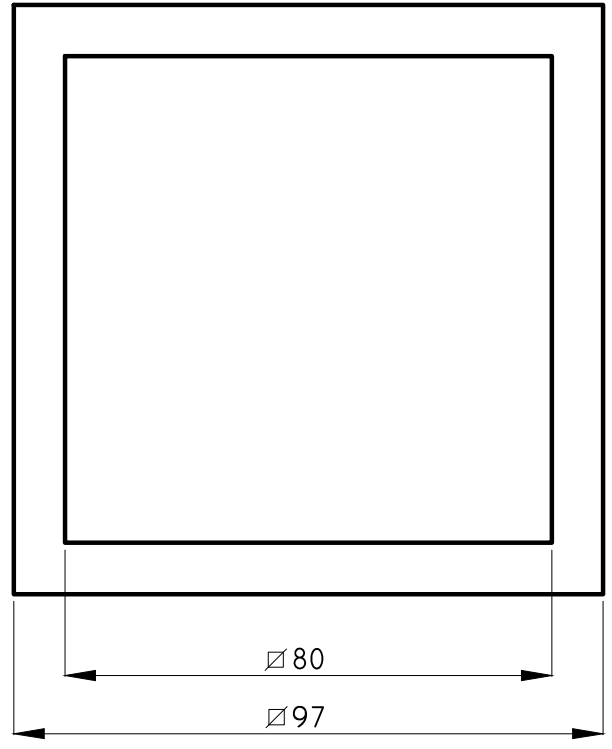

7

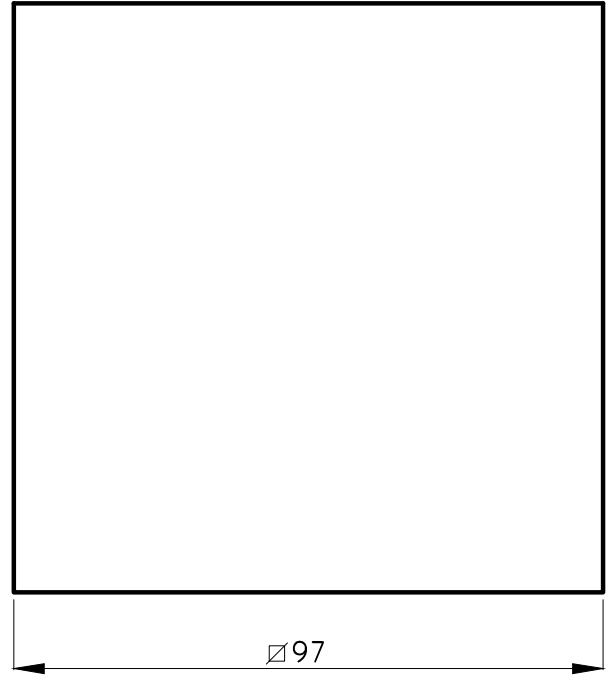

TODAS LAS PIEZAS EN MDF (FIBRO-FACIL) DE 3 MM
 LA PIEZA 6 SE DEBE PEGAR SOBRE LA PIEZA 7 PARA CONSEGUIR EL MARCO DONDE DEBEN ENCAJARSE LAS PIEZAS 1 A 5.